

# Battery switch 275A



Label stickers

## Battery Switch 275A

The Battery Switch has a continuous current rating and is suitable for battery systems up to 48V. It has a unique ergonomic and aesthetic knob design for easy operation.

### Usages

The Battery Switch can be used to isolate a battery from DC loads and/or DC charge sources. It is used to preserve battery charge in case a system is unattended, for system maintenance or in an emergency.

It can also be used to parallel connect the house battery to the starter battery to supplement a flat starter battery or a flat house battery in case of an emergency.

### Installation

The Battery Switch can be either surface or panel mounted, providing flexibility during install. It features 4 easily removable side panels for cable access. It ships with 16 different label stickers, for customization of the Battery Switch.

### Safety

The knob is removable for isolation or safety purposes. The Battery Switch meets the ISO8846 Ignition Protection standard and is suitable for use in an engine room.

Battery switch	
Max. continuous current	275 A
One minute rating	455 A
Cranking rating	1250 A
Maximum operating voltage	60 V
Terminal material	Tin-plated copper
Hex nut material	Tin-plated copper
Terminal diameter	M10 (3/8 inch / 9.53 mm)
Recommended torque	70 lbf-inch / 8 N-m
Base material	Glass fiber reinforced nylon
Weight	0.4 lb / 0.2 kg
Dimensions (l x w x h)	2.7 x 3.0 x 2.7 inch 69.5 x 76.3 x 69.5 mm
Mounting	Surface or rear panel mount
Ignition protected	ISO8846 / SAE J1171

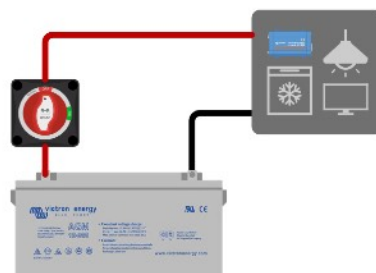

The Battery Switch is used to isolate the battery from a DC system.

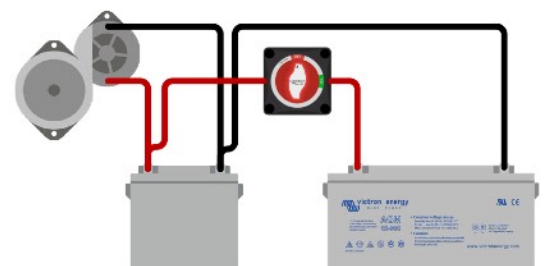

The Battery Switch is used as an emergency parallel switch.